

Model SMTM Micro S-Type Load Cell

- Capacity 5 to 50 lb (20 to 200N)
- Can be used in tension & compression
- Micro sized 3/4" x 3/4" x 1/4"
- Excellent temperature compensation (0.005%/°F Temp Effect on Output)
- Overload protected

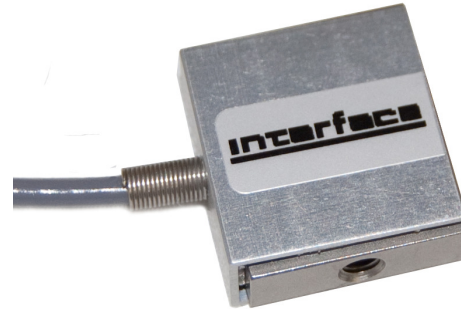

STANDARD CONFIGURATION

5 ft Integral Cable

OPTIONS

Alternate Cable Length
Standardized Output ($\pm 0.1\%$)
Metric Calibration & Threads

ACCESSORIES

Instrumentation
Mounting Hardware

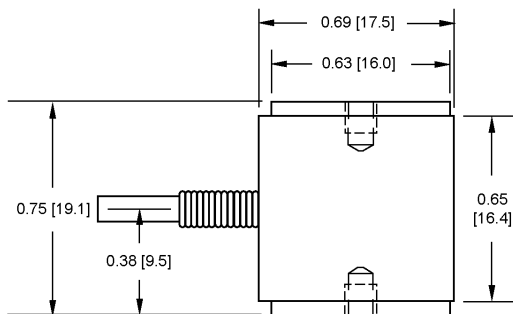
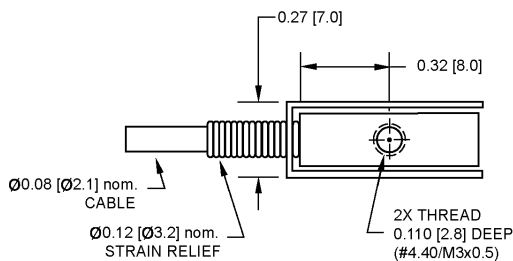

SPECIFICATIONS

ACCURACY – (MAX ERROR)	
Nonlinearity-% FS	± 0.1
Hysteresis-% FS	± 0.1
Nonrepeatability-% RO	± 0.05
Creep in 20 min-%	± 0.1
TEMPERATURE	
Compensated Range-°F	60 to 165
Compensated Range-°C	15 to 75
Operating Range-°F	-55 to 200
Operating Range-°C	-50 to 95
Effect on Output-%/°F – MAX	± 0.005
Effect on Output-%/°C – MAX	± 0.010
Effect on Zero- % RO/°F – MAX	± 0.015
Effect on Zero- % RO/°C – MAX	± 0.018
ELECTRICAL	
Rated Output-mV/V (Nominal)	2.0
Zero Balance-%RO	± 3.0
Bridge Resistance-Ohm (Nominal)	350
Excitation Voltage-MAX	5 VDC
Insulation Resistance-Megohm	>2500
MECHANICAL	
Calibration	Tension
Safe Overload-% CAP	1000**
Cable Length-ft	5

**50 lb. capacity rated to 300% CAP