

SYSTEM COMPONENTS MODEL 5310M1, 1 EA. :

- 3030C1**- CHARGE MODE ACCELEROMETER
- 6019B10** - LOW NOISE CABLE, 10-32 TO BNC WITH 6549 ENVIRONMENTAL SEALING BOOT
- 4705M16** - IN-LINE CHARGE AMPLIFIER

SYSTEM SENSITIVITY: 5 mV/G

PORT PREPARATION:
 PREPARE FLAT SURFACE OVER Ø .500 AREA.
 AT CENTER DRILL #21(Ø .159) X .25 DEEP MIN
 BOTTOM TAP #10-32 UNC-2B X .150 DEEP MIN

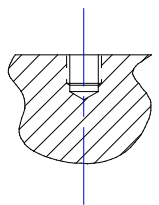

DYTRAN INSTRUMENTS, INC.		CHATSWORTH, CA.	
SCALE	1X	REV	DATE
DATE	12/14/99	PART NO.	MODEL 5310M2
DRAWN	N.C.	CHECKED	R.A.
APPROVED		NEXT ASSEMBLY	USED ON
TITLE		5310M2	
OUTLINE/INSTALLATION DRAWING, SYSTEM MODEL 5310M2		DWG NO. 127-5310M2	
		SHEET 1 OF 1	

EXCEPT AS OTHERWISE NOTED

ALL DIMENSIONS IN INCHES
 TOLERANCE: .XXX = ± .005 .XX = ± .01

SURFACE FINISH 63 ✓
 EXCEPT AS NOTED

BREAK EDGES TO DEBURR .003
 RADIUS OR CHAMFER

△ THESE DIAS ⊙ TO T.I.R.

FILLET - .005 MAX RAD.

ALL PART NUMBER LETTERSUFFIXES ARE TO BE INTERPRETED AS FOLLOWS:

M - MACHINED ONLY (UNPLATED) G - MATERIAL HAS BEEN GRAINED
 P - PLATED/PAINTED S - MATERIAL HAS BEEN SAWCUT
 H - HEAT TREATED E - ENVIRONMENTAL TEST

I.E. - 107-0000-01 (X)

SPECIFICATIONS

MODEL 3030C1 MINIATURE HIGH TEMPERATURE ACCELEROMETER

SPECIFICATION	VALUE	UNITS
RANGE F.S.	± 500	G
SENSITIVITY, @ 100 Hz 1G RMS, NOM.	0.40	pC/G
FREQUENCY RESPONSE, ±5%	5 to 10,000	Hz
RESONANT FREQUENCY	30	kHz
LINEARITY [1]	± 1	% FS
OUTPUT IMPEDANCE, NOM	100	OHMS
TRANSVERSE SENSITIVITY, MAX	5	%
TEMPERATURE RANGE	-100 to +500	DEG F
THERMAL COEFFICIENT OF SENSITIVITY	0.01	%/DEG F
CAPACITANCE	126	pF
MAX VIBRATION	1000	G,RMS
MAX SHOCK	3000	G, PEAK
SIZE, HEX X HEIGHT (NOT INCL STUD)	0.375 X 0.67	IN
WEIGHT	6.8	GRAMS
CONNECTOR, TOP MOUNTED	10-32	MICRO COAX
CASE MATERIAL	316L	STAINLESS STEEL
SEAL	WELDED/GLASS TO METAL	HERMETIC
MOUNTING PROVISION	10-32 (UNC-2A)	INTEGRAL STUD

NOTES:

[1] OVER ANY CALIBRATED LESSER RANGE WITHIN FULL SCALE RANGE, BEST FIT STRAIGHT LINE METHOD.

