

**PROPRIETARY AND CONFIDENTIAL**

THE INFORMATION CONTAINED IN THIS DRAWING IS THE SOLE PROPERTY OF DYTRAN INSTRUMENTS INC. ANY REPRODUCTION IN PART OR AS A WHOLE WITHOUT THE WRITTEN PERMISSION OF DYTRAN INSTRUMENTS INC. IS PROHIBITED

**REVISIONS**

REV	ECN	DESCRIPTION	BY/DATE	CHK	APPR
B	8293	SEE ECN	LN, 02/13/12	<i>[Signature]</i>	<i>[Signature]</i>

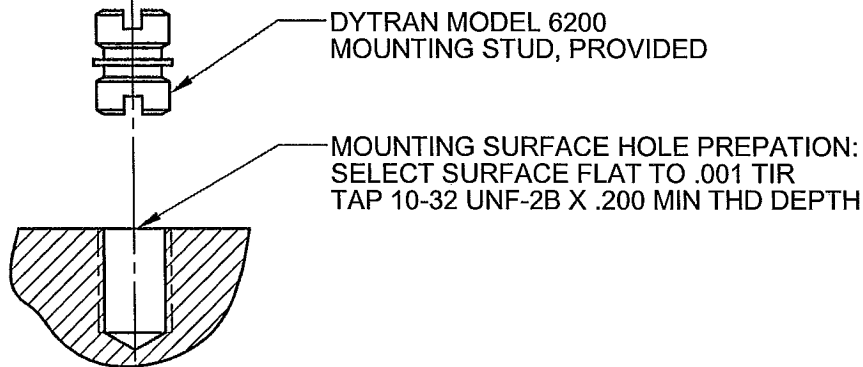
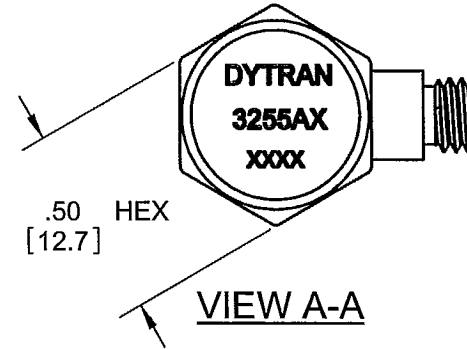
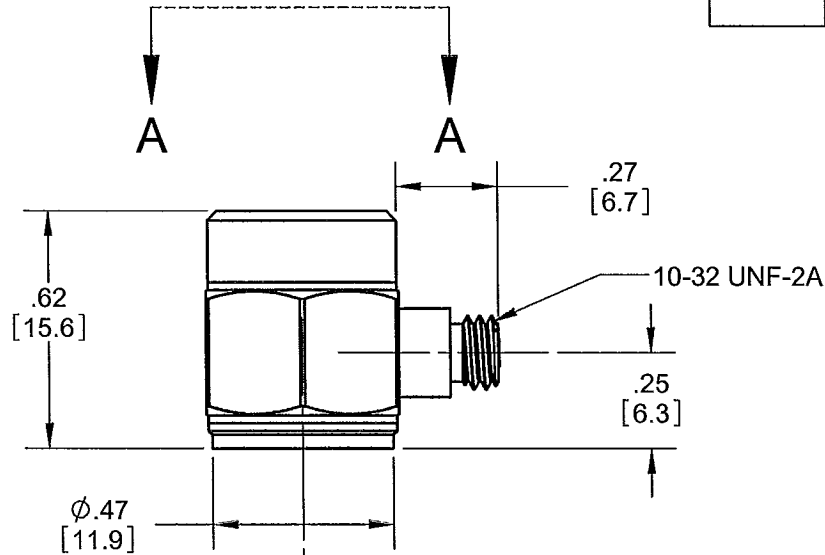

MODEL	SENSITIVITY
3255A1	10 mV/g
3255A2	100 mV/g
3255A3	500 mV/g
3255A4	50 mV/g
3255A5	20 mV/g
3255A6	200 mV/g

UNLESS OTHERWISE SPECIFIED:  
 INTERPRET DIM & TOL PER ASME Y14.5M - 1994.  
 REMOVE BURRS.  
 COUNTERSINK INTERNAL THDS 90° TO MAJOR DIA.  
 CHAM EXT THDS 45° TO MINOR DIA.  
 THD LENGTHS AND DEPTHS ARE FOR MIN FULL THDS.  
 THDS PER MIL-S-7742.  
 DIMENSIONS APPLY AFTER FINISHING.

ALL MACHINED SURFACES. <sup>63</sup>  
 TOTAL RUNOUT WITHIN .005.  
 BREAK SHARP EDGES .005 TO .010.  
 MACHINED FILLET RADII .005 TO .015.  
 WELDING SYMBOLS PER AWS A2.4.  
 ABBREVIATIONS PER MIL-STD-12.

USED ON \_\_\_\_\_ NEXT ASSY \_\_\_\_\_  
 APPLICATION \_\_\_\_\_

THIRD ANGLE PROJECTION  
 USA

UNLESS OTHERWISE SPECIFIED:  
 DIMENSIONS ARE IN INCHES.  
 DIMENSIONS IN BRACKETS [ ]  
 ARE IN MILLIMETERS  
 TOLERANCES ARE:  
 INCHES METRIC ANGLES  
 .XX ± .03 .X ± 0.8 ± 1°  
 .XXX ± 0.10 .XX ± 0.25

MATERIAL  
**Ti6Al-4V**

FINISH \_\_\_\_\_

DO NOT SCALE DRAWING

CONTRACT NO. \_\_\_\_\_

APPROVALS		DATE
ORIG	RA	02/05/07
CHK	CES	02/09/07
APP	CES	02/09/07
APP		

**DYTRAN INSTRUMENTS, INC. MASTER COPY**  
**ONLY IN RED**

TITLE:  
**OUTLINE/INSTALLATION DRAWING,  
 3255A SERIES ACCELEROMETER**

SIZE <b>A</b>	CAGE CODE <b>2W033</b>	DWG. NO. <b>127-3255A</b>	REV <b>B</b>
------------------	---------------------------	------------------------------	-----------------

SCALE: NONE      SOLIDWORKS      SHEET 1 OF 1



- HERMETICALLY SEALED
- IDEAL LOW FREQUENCY RESPONSE

**This family also includes:**

Model	Sensitivity (mV/g)	Frequency Response, ±5 % (Hz)	Time Constant (Sec)	Operating Temp (°F)
3225A2	100	1 to 10000	0.5 to 1.2	-60 to +250
3225A3	500	1 to 10000	0.5 to 1.2	-60 to +225
3225A4	50	1 to 10000	0.5 to 1.2	-60 to +250
3225A5	20	1 to 10000	0.5 to 1.2	-60 to +250
3225A6	200	1 to 10000	0.5 to 1.2	-60 to +225

Refer to the performance specifications of the products in this family for detailed description

**Supplied Accessories:**

- 1) Accredited calibration certificate (ISO 17025)
- 2) Model 6200 mounting stud, qty 1

**Notes:**

- [1] Measured at 100Hz, 1 Grms per ISA RP 37.2.
- [2] Measure using zero-based straight line method, % of F.S. or any lesser range.
- [3] Do not apply power to this system without current limiting, 20 mA MAX. To do so will destroy the IC charge amplifier.
- [4] In the interest of constant product improvement, we reserve the right to change specifications without notice.

**PHYSICAL**  
Weight  
Connector  
Mounting Provision  
Material, Housing/Connector  
Sensing Element  
Element Style

ENGLISH		SI	
Weight	0.35 oz	Weight	10.0 grams
Connector	10-32	Connector	10-32
Mounting Provision	10-32 X .150 DEEP	Mounting Provision	10-32 X .150 DEEP
Material, Housing/Connector	Titanium	Material, Housing/Connector	Titanium
Sensing Element	Ceramic	Sensing Element	Ceramic
Element Style	Planar Shear	Element Style	Planar Shear

**PERFORMANCE**  
Sensitivity, ± 5% [1]  
Range for ± 5 Volts Output  
Frequency Response, ± 5%  
Resonant Frequency  
Broad Band Resolution  
Linearity [2]  
Maximum Transverse sensitivity  
Strain Sensitivity @ 250µε

Sensitivity, ± 5% [1]	10 mV/g	Sensitivity, ± 5% [1]	1 mV/m/s <sup>2</sup>
Range for ± 5 Volts Output	± 500 g	Range for ± 5 Volts Output	± 4905 m/s <sup>2</sup>
Frequency Response, ± 5%	1 to 10000 Hz	Frequency Response, ± 5%	1 to 10000 Hz
Resonant Frequency	> 35 kHz	Resonant Frequency	> 35 kHz
Broad Band Resolution	0.001 Grms	Broad Band Resolution	0.010 m/s <sup>2</sup> rms
Linearity [2]	± 2 % F.S.	Linearity [2]	± 2 % F.S.
Maximum Transverse sensitivity	5 %	Maximum Transverse sensitivity	5 %
Strain Sensitivity @ 250µε	0.002 g/µε	Strain Sensitivity @ 250µε	0.02 m/s <sup>2</sup> /µε

**ENVIRONMENTAL**  
Maximum Vibration  
Maximum Shock  
Temperature Range  
Seal

Maximum Vibration	600 Gpeak	Maximum Vibration	5886 m/s <sup>2</sup> peak
Maximum Shock	3000 Gpeak	Maximum Shock	29430 m/s <sup>2</sup> peak
Temperature Range	-60 to +250 °F	Temperature Range	-51 to 121 °C
Seal	Hermetic	Seal	Hermetic

**ELECTRICAL**  
Supply Current Range [3]  
Compliance Voltage Range  
Output Impedance, Typ  
Bias Voltage  
Discharge Time Constant

Supply Current Range [3]	2 to 20 mA	Supply Current Range [3]	2 to 20 mA
Compliance Voltage Range	18 to +30 Volts	Compliance Voltage Range	18 to +30 Volts
Output Impedance, Typ	100 Ω	Output Impedance, Typ	100 Ω
Bias Voltage	11 to 13 VDC	Bias Voltage	11 to 13 VDC
Discharge Time Constant	0.5 to 1.2 Sec	Discharge Time Constant	0.5 to 1.2 Sec

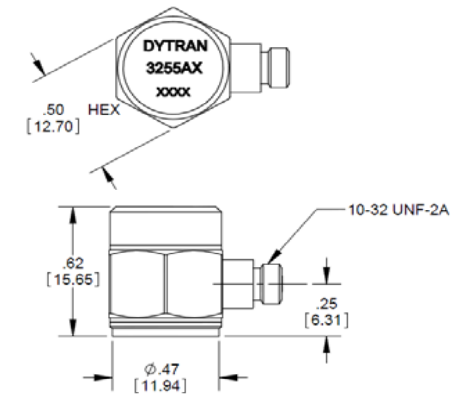
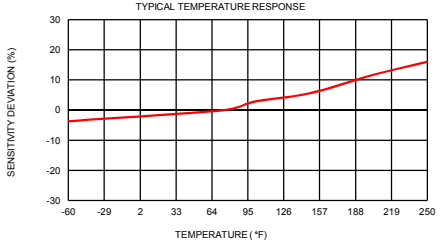
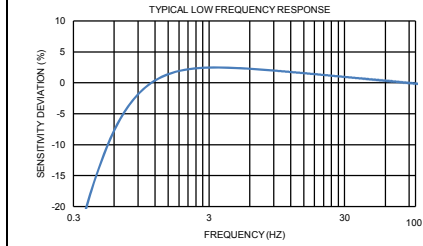

Units on the line drawing are in inches, units in brackets are in millimeters. Refer to 127-3255A for more information.



21592 Marilla Street, Chatsworth, California 91311 Phone: 818.700.7818 Fax: 818.700.7880 www.dytran.com  
For permission to reprint this content, please contact info@dytran.com