

DYTRAN PROPRIETARY AND CONFIDENTIAL
 THE INFORMATION CONTAINED IN THIS DRAWING IS THE SOLE PROPERTY OF
 DYTRAN INSTRUMENTS, INC. AND ANY REPRODUCTION IN PART OR AS A
 WHOLE OR ANY OTHER DISSEMINATION OF THIS INFORMATION WITHOUT THE
 WRITTEN PERMISSION OF DYTRAN INSTRUMENTS, INC. IS PROHIBITED.

REV	ECN	DESCRIPTION	BY/DATE	CHK	APPR
A	8152	INITIAL RELEASE	NC/12-5-11	<i>AV</i>	<i>ANS</i>

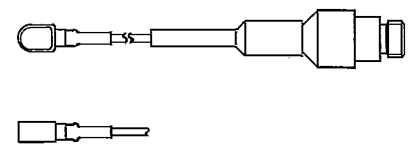
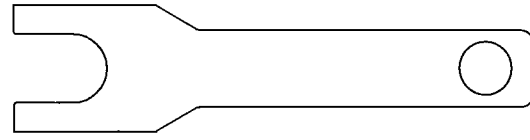
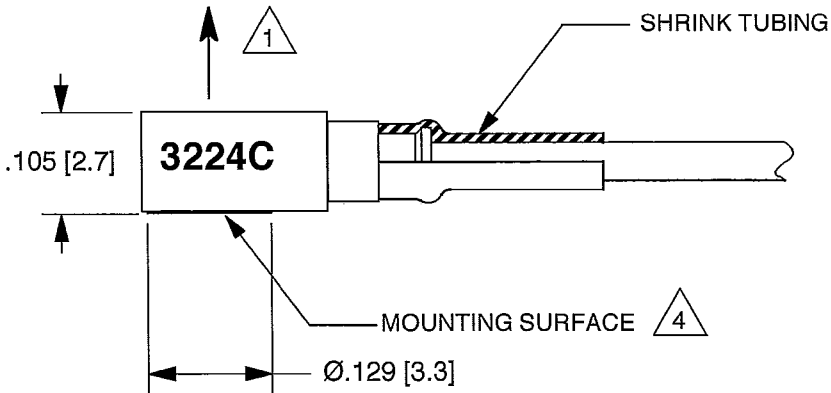
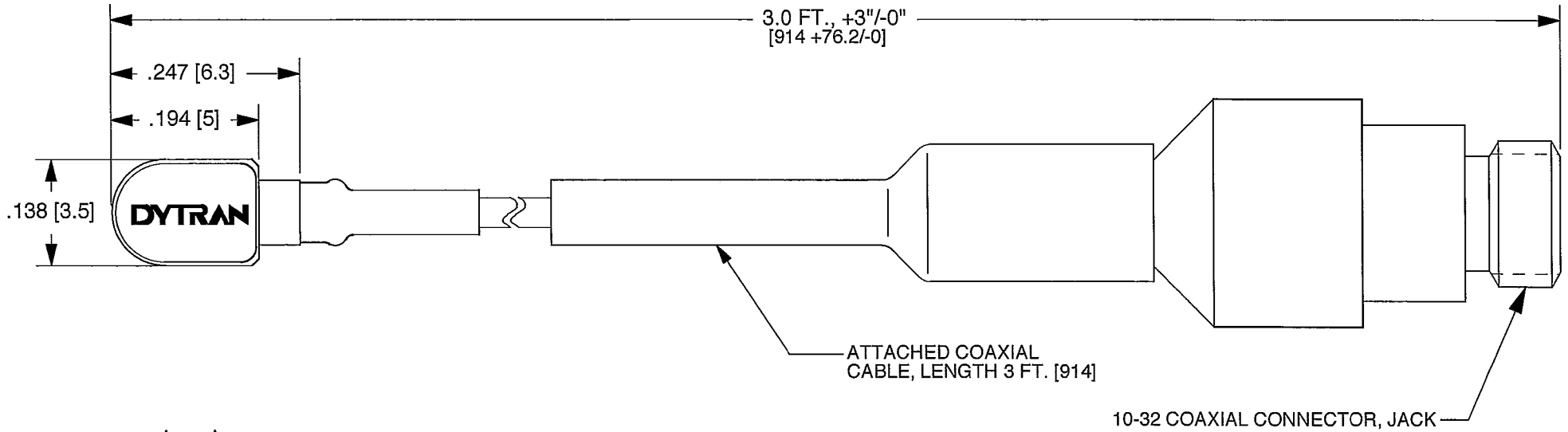

- △ 4 APPLY ADHESIVE TO THIS SURFACE TO MOUNT.
- 3. CASE AND CONNECTOR MATERIAL: TITANIUM.
- 2. WEIGHT LESS CABLE: 0.2 GRAMS.
- △ 1 ARROW INDICATES SENSE AND DIRECTION OF INPUT ACCELERATION FOR NEGATIVE GOING OUTPUT SIGNAL.

UNLESS OTHERWISE SPECIFIED:
 DIMENSIONS ARE IN INCHES. DIMENSIONS IN
 BRACKETS [] ARE IN MILLIMETERS.
 TOLERANCES ARE:

INCHES	METRIC	ANGLES
.XX ±.03	.X ±0.8	±1°
.XXX ±.005	.XX ±0.25	

CHATSORTH, CA.

MASTER ONLY IF IN RED

SCALE 5X	DESIGN N.C.	DATE 12/5/11			
DRAWN N.C.	DATE 12/5/08	PART NO. MODEL 3224C			
CHECKED <i>AV</i>	DATE 12/19/11	MAT'L			A
APPROVED <i>ANS</i>	DATE 12/19/11	NEXT ASSEMBLY	USED ON		
TITLE OUTLINE/INSTALLATION DRAWING, MODEL 3224C ACCELEROMETER, CHARGE MODE			DWG NO. 127-3224C		
SHEET 1 OF 1					

MODEL NUMBER 3224C	PERFORMANCE SPECIFICATION	DOC NO. PS3224C
-------------------------------------	----------------------------------	----------------------------------

	IEPE ACCELEROMETER	REV B, ECN 8713,06/07/12
--	---------------------------	--------------------------



- **MINIATURE SIZE**
- **HIGH SENSITIVITY**
- **EPOXY SEALED CABLE CONNECTION**
- **CHARGE MODE**

PHYSICAL

	ENGLISH		SI	
Weight, Less Cable Size	0.007	oz	0.2	grams
Width	0.138	in	3.5	mm
Length	0.25	in	6.4	mm
Height	0.105	in	2.7	mm
Mounting Provision	[1]		[1]	
Connector [2]	Integral cable		Integral cable	
Sensing Element	Planar Shear Piezoceramic		Planar Shear Piezoceramic	

PERFORMANCE

Sensitivity [3] [4]	>0.60	pC/g	>0.06	pC / m/s ²
Range F.S.	250	g	2452	m/s ⁴
Frequency Response, ±5% [4] [5]	to 10000	Hz	to 10000	Hz
Resonant Frequency	>40	kHz	>40	kHz
Amplitude Non-Linearity [6]	2	%F.S MAX	2	%F.S MAX
Transverse Sensitivity, Max.	5	%	5	%
Strain Sensitivity @250µε	0.0005	g/µε	0.005	m/s ² /µε

ENVIRONMENTAL

Maximum Vibration	250	g rms	2450	m/s ² rms
Maximum Shock	1000	g pk	9800	± m/s ⁴ pk
Temperature Range	-60 to +350	°F	-51 to 177	°C
Seal	Epoxy		Epoxy	

ELECTRICAL

Capacitance Including 1.5 FT 6001A01.5 Cable	220	pF	220	pF
Insulation Resistance @ R.T.	5 x 10 ⁸ Min.	OHMS	5 x 10 ⁸ Min.	OHMS
Output Signal Polarity for Acceleration Toward Top	Negative going		Negative going	

This family also includes:

Model	Sensitivity (mV/g)	Range (Gpeak)	Resolution (Grms)	Oper. Temp(°F)	TC (sec)

Please, refer to the performance specifications of the products in this family for detailed description.

Supplied Accessories:

- 1) Model 6725 installation removal wrench.
- 2) Sample of " Small Petro Mounting Wax".
- 3) Accredited calibration certificate (ISO 17025)

Notes:

- [1] Flat mounting surface for adhesive mount.
- [2] 10-32 Coaxial Jack at end of 3FT.cable
- [3] Measured at 100 Hz, 1 G rms per ISA RP 37.2.
- [4] Actual sensitivity is given on a calibration certificate traceable to NIST, supplied with each instrumen
- [5] Low frequency response is a function of the charge amplifier discharge time constant.
- [6] Zero based on best fit straight line method.

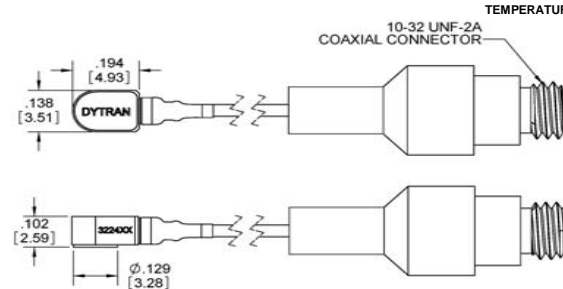
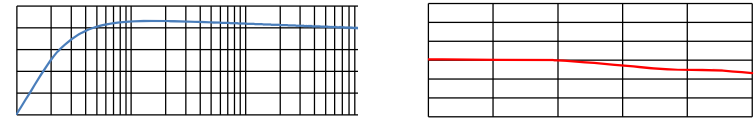

Units on the line drawing are in inches, units in brackets are in millimeters. Refer to 127-3224A1 for more information.



21592 Marilla Street, Chatsworth, California 91311 Phone: 818.700.7818 Fax:818.700.7880 www.dytran.com For permission to reprint this content, please contact info@dytran.com